

# LOCAL DEVELOPMENT PLAN

## LOTS 14-19 AACHEN CRESCENT, GWELUP

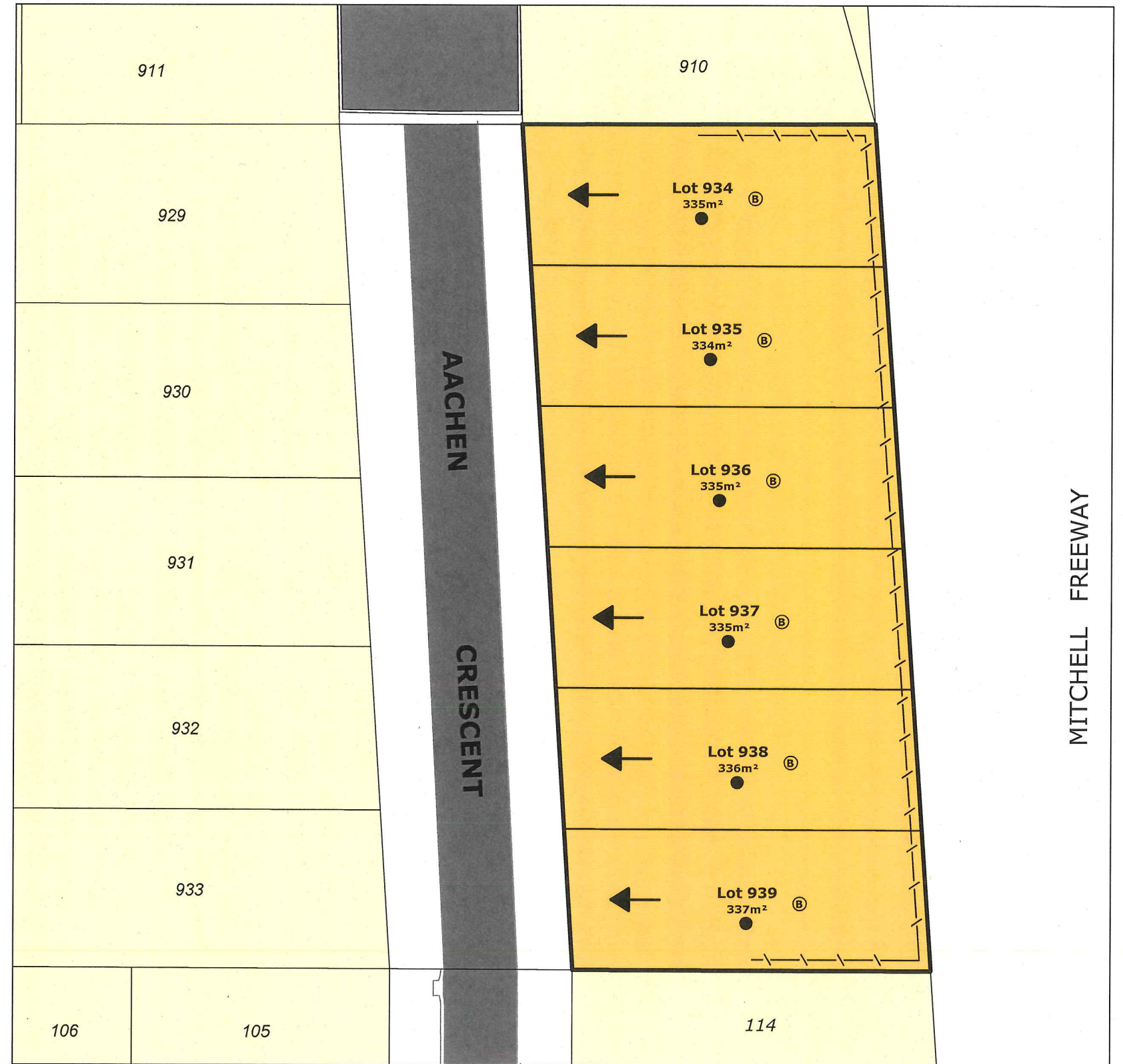
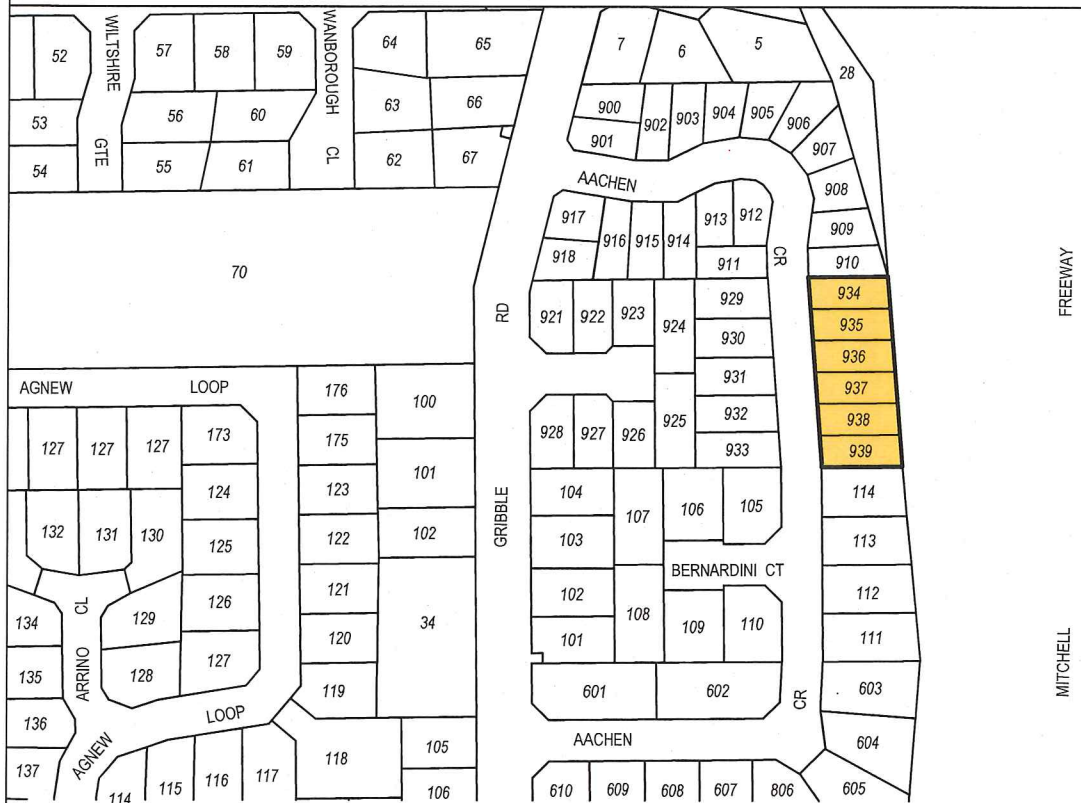

### LOCAL DEVELOPMENT PLAN PROVISIONS:

This Local Development Plan (LDP) has been prepared pursuant to Clause 52(1)(a) of the Planning and Development (Local Planning Schemes) Regulations 2015 - Schedule 2 - Deemed Provisions and the Residential Design Codes.

#### Quiet House Design:

- 1) Dwellings on lots identified as requiring "Quiet House Design" are to be constructed in accordance with the relevant "Deemed to Comply Noise Treatment Package" specified on this LDP. Further guidance on Acceptable Noise Treatment Package requirements can be found in the Implementation Guidelines for State Planning Policy 5.4

### Approval:

Pursuant to Clause 52(1)(1) of the Planning and Development (Local Planning Schemes) Regulations - 2015 Schedule 2 - Deemed Provisions this Local Development Plan is hereby approved.

Authorised Officer:

Date:

26/2/2019

### LEGEND

- EXTENT OF LOCAL DEVELOPMENT PLAN
- LOTS REQUIRING NOTIFICATION ON TITLE IN REGARDS TO TRANSPORT NOISE
- 1.8m HIGH ACOUSTIC BARRIER/DOUBLE SKIM COLORBOND FENCE ABOVE MIN 1.7m HIGH RETAINING WALL
- LOT ORIENTATION
- QUIET HOUSE DESIGN (IMPLEMENTATION GUIDELINES SPP 5.4 - PACKAGE B) IF TWO STOREY HOUSE CONSTRUCTED
- SPECIAL USE (RESIDENTIAL R30)



0 5 10  
1:400 @ A3

**THE LAND DIVISION**  
PLANNING | SURVEYING | DESIGN

PO BOX 2444, MALAGA, WA 6090  
T: 9209 3232 | F: 9249 2551  
E: INFO@LANDDIVISION.COM.AU

JOB NUMBER: 18-8028 DRAFTING DATE: 6-02-2019